UTEK

MECHANICAL SEALS



www.utekseal.com

U2203 ve U2232

Equivalent to Burgmann M3, M32, M37

Unit of Measure = Metric

D1	D3	D13	L1n	L3	L22	L23
10	19	20	40	15.5	16.9	—
12	21	22	40	16.0	17.4	—
14	23	24	40	16.5	17.4	16.5
15	24	25	—	—	17.4	16.5
16	26	26	40	18.0	19.5	16.5
18	29	31	45	19.5	20.5	18.5
20	31	34	45	22.0	22.0	19.0
22	33	36	45	21.5	23.5	20.5
24	35	38	50	23.5	25.0	22.0
25	36	39	50	26.5	26.5	23.5
28	40	42	50	26.5	26.5	24.5
30	43	44	50	26.5	25.0	24.5
32	46	46	55	28.5	28.5	28.0
33	47	47	55	28.5	28.5	28.0
35	49	49	55	28.5	28.5	28.0
38	53	54	55	33.5	32.2	31.0
40	56	56	55	36.0	34.7	34.0
42	59	58	—	—	37.3	35.0
43	59	59	60	38.5	37.3	35.0
45	61	61	60	39.5	39.2	36.5
48	64	64	60	46.0	44.7	42.0
50	66	66	60	45.0	45.7	43.0
53	69	69	70	47.0	—	—
55	71	71	70	49.0	49.0	47.0
58	76	78	70	55.0	52.0	50.0
60	78	79	70	55.0	53.0	51.0
63	83	83	70	55.0	—	—
65	84	85	80	55.0	54.3	52.0
68	88	88	80	55.0	55.3	52.7
70	90	90	80	57.0	56.3	54.0
75	98	98	80	62.0	56.3	54.0
80	100	103	90	61.8	59.3	58.0

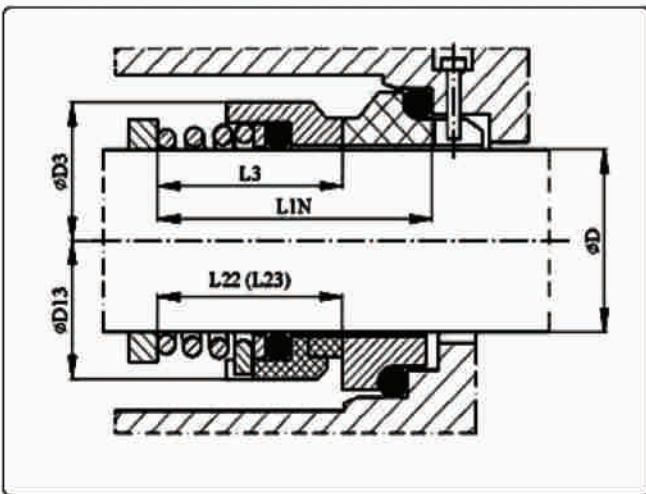

U2030

Equivalent to Roten

d	D	D1	L1	L2
16	28,5	26,9	7	28,2
18	32,5	30,9	8	30,2
19	32,5	30,9	8	30,2
20	32,5	30,9	8	30,2
21	37	35,4	8	30,2
22	37	35,4	8	30,2
24	37	35,4	8	32,2
25	40,5	38,2	8,5	33,2
28	46,5	43,3	9	36,2
30	46,5	43,3	9	37,2
32	46,5	43,3	9	37,2
33	56,5	53,5	11,5	48,2
35	56,5	53,5	11,5	48,2
38	63	60,5	11,5	48,2
40	63,5	60,5	11,5	48,2
42	63,5	60,5	11,5	48,2
43	63,5	60,5	11,5	48,2
45	68,5	65,5	11,5	51,2
48	68,5	65,5	11,5	51,2
50	75	72,5	11,5	55,2
55	75	72,5	11,5	57,2
60	83	79,3	11,5	61,2
65	88	84,5	11,5	63,2
70	93	89,5	11,5	63,2
75	98	94,5	11,5	68,2
80	103	99,5	11,5	70,2
85	117	105,5	13,5	72,2
90	122	111,5	13,5	75,2
95	129	116,5	13,5	75,2
100	135	119,5	13,5	85,2

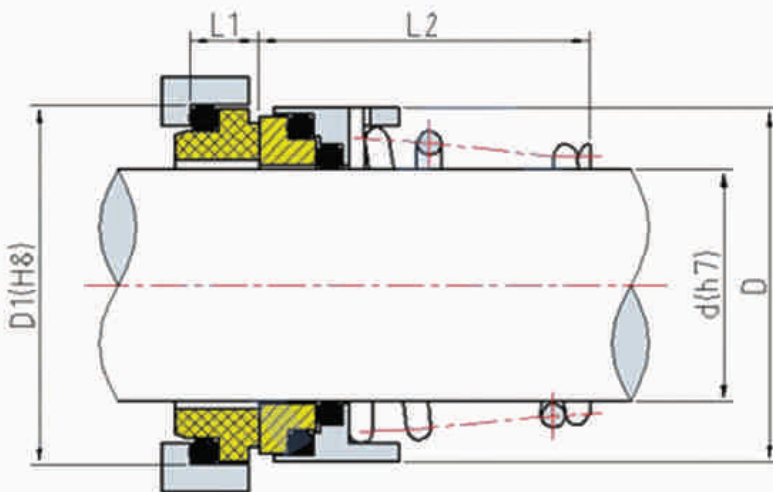

U2025

Shaft Size D	Size Code	D1	D2	D3	L1	L2	L3
10	0100	18.10	14.00	19.50	15.00	5.50	4.00
11	0110	20.60	16.50	22.00	18.00	5.50	4.00
12	0120	20.60	16.50	22.80	18.00	5.50	4.00
13	0130	23.10	19.00	25.00	22.00	6.00	4.00
14	0140	23.10	19.00	25.00	22.00	6.00	4.00
15	0150	26.90	21.00	28.60	22.00	7.00	5.00
16	0160	26.90	21.00	28.60	23.00	7.00	5.00
17	0170	26.90	21.00	28.60	23.00	7.00	5.00
18	0180	30.90	25.00	32.70	24.00	8.00	5.00
19	0190	30.90	25.00	32.70	25.00	8.00	5.00
20	0200	30.90	25.00	32.70	25.00	8.00	5.00
21	0210	35.40	30.00	37.40	25.00	8.00	5.50
22	0220	35.40	30.00	37.40	25.00	8.00	5.50
23	0230	35.40	30.00	37.40	27.00	8.00	5.50
24	0240	35.40	30.00	37.40	27.00	8.00	5.50
25	0250	38.20	33.00	40.00	27.00	8.50	5.50
28	0280	43.30	38.00	45.50	29.00	9.00	5.50
29	0290	43.30	38.00	45.50	30.00	9.00	5.50
30	0300	43.30	38.00	45.50	30.00	9.00	5.50
32	0320	43.30	38.00	45.50	30.00	9.00	5.50
33	0330	53.50	45.00	48.00	39.00	11.50	7.50
35	0350	53.50	45.00	50.00	39.00	11.50	7.50
38	0380	60.50	52.00	56.00	39.00	11.50	7.50
40	0400	60.50	52.00	58.00	39.00	11.50	7.50

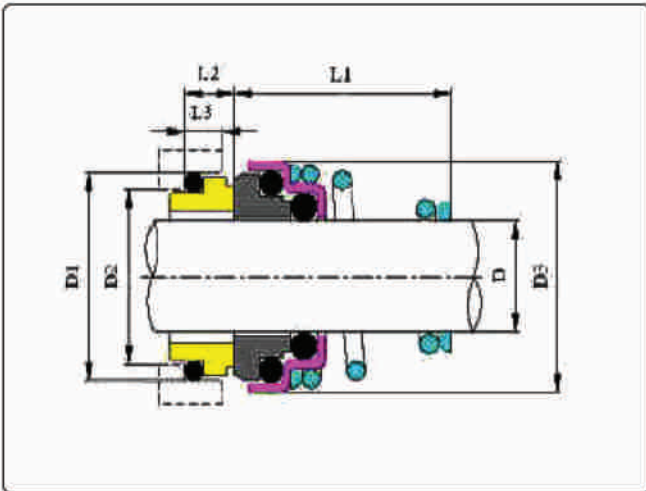

U2027

Metric Shaft Size (D)	Size Code	D1	D2	D3	L1	L2	L3
8	080	26,00	11,00	24,00	11,00	8,00	6,00
10	100	26,00	11,00	24,00	11,00	8,00	6,00
11	110	26,00	13,00	24,00	11,00	8,00	6,00
12	120A	26,00	14,00	24,00	11,00	8,00	6,00
12	120B	26,00	13,00	24,00	13,00	8,00	6,00
12	120C	35,00	16,00	32,00	13,00	8,00	6,00
13	130	26,00	14,00	24,00	13,00	8,00	6,00
14	140	35,00	16,00	32,00	13,00	8,00	6,00
15	150	38,00	18,00	35,00	13,00	8,00	6,00
16	160A	38,00	18,00	35,00	13,00	8,00	6,00
16	160B	42,00	21,00	39,00	13,00	8,00	6,00
17	170	42,00	21,00	39,00	13,00	8,00	6,00
18	180	42,00	21,00	39,00	13,00	8,00	6,00
19	190	42,00	21,00	39,00	13,00	8,00	6,00
20	200A	42,00	21,00	39,00	13,00	8,00	6,00
20	200B	45,00	23,00	42,00	13,00	10,00	8,00
22	220	45,00	23,00	42,00	13,00	10,00	8,00
23	230	50,00	27,00	47,00	14,00	10,00	8,00
24	240	50,00	27,00	47,00	14,00	10,00	8,00
25	250	50,00	27,00	47,00	14,00	10,00	8,00
28	280	57,00	34,00	54,00	15,00	10,00	8,00
30	300	57,00	34,00	54,00	15,00	10,00	8,00
32	320	57,00	34,00	54,00	15,00	10,00	8,00
35	350	63,00	37,00	60,00	16,00	10,00	8,00
38	380	68,00	42,00	65,00	17,00	12,00	9,00
40	400	68,00	42,00	65,00	17,00	12,00	9,00
45	450	73,00	47,00	70,00	20,00	12,00	9,00
50	500	88,00	52,00	85,00	20,00	15,00	12,00
60	600	110,00	67,00	110,00	30,00	15,00	12,00
65	650	110,00	67,00	110,00	30,00	15,00	12,00
70	700	110,00	72,00	105,00	32,00	15,00	12,00

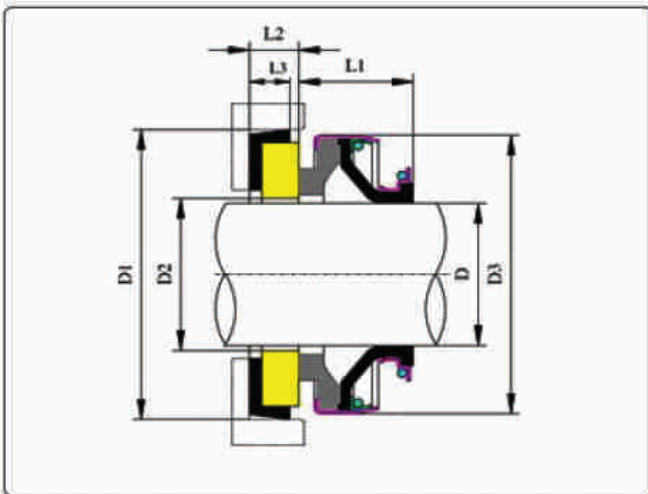

U2052

Metric Shaft Size D	D1	D2	D3	L1	L2	L3	L4
10	24,60	16,00	22,95	43,65	25,40	8,74	7,47
12	27,79	19,05	23,90	43,65	25,40	8,74	7,47
13	27,79	19,05	23,90	43,65	25,40	8,74	7,47
14	30,95	22,23	26,70	43,65	25,40	10,32	8,97
15	30,95	22,23	26,70	43,65	25,40	10,32	8,97
16	30,95	22,23	26,70	43,65	25,40	10,32	8,97
18	34,15	25,40	31,10	43,65	25,40	10,32	8,97
19	34,15	25,40	31,10	43,65	25,40	10,32	8,97
20	35,70	26,99	33,40	43,65	25,40	10,32	8,97
22	37,30	28,58	33,40	43,65	25,40	10,32	8,97
24	40,50	31,75	39,20	43,65	25,40	10,32	8,97
25	40,50	31,75	39,20	43,65	25,40	10,32	8,97
28	47,63	35,72	46,30	60,33	33,34	11,99	10,46
30	50,80	38,80	49,40	60,33	33,34	11,99	10,46
32	50,80	38,80	49,40	60,33	33,34	11,99	10,46
33	53,98	42,07	52,60	60,33	33,34	11,99	10,46
34	53,98	42,07	52,60	60,33	33,34	11,99	10,46
35	53,98	42,07	52,60	60,33	33,34	11,99	10,46
38	57,15	45,24	55,80	60,33	33,34	11,99	10,46
40	60,35	46,82	62,20	60,33	33,34	11,99	10,46
42	63,50	51,59	65,00	70,64	40,48	11,99	10,46
43	63,50	51,59	65,00	70,64	40,48	11,99	10,46
44	63,50	51,59	65,00	70,64	40,48	11,99	10,46
45	63,50	51,59	65,00	70,64	40,48	11,99	10,46
48	66,70	54,75	65,60	70,64	40,48	11,99	10,46
50	69,85	56,00	71,05	70,64	40,48	11,99	10,46
53	73,05	62,00	73,30	71,00	41,00	13,50	11,96
55	76,20	65,00	78,40	71,00	41,00	13,50	11,96
58	79,40	68,00	82,00	71,00	41,00	13,50	11,96
60	79,40	68,00	82,00	71,00	41,00	13,50	11,96
63	82,55	71,20	84,90	71,00	41,00	13,50	11,96
65	92,10	78,35	88,40	70,00	49,00	15,90	14,50
70	95,25	81,10	92,60	70,00	49,00	15,90	14,50
73	98,45	84,50	94,85	73,00	49,00	15,90	14,50
75	101,65	88,10	101,90	73,00	49,00	15,90	14,50
80	114,30	97,00	104,00	79,00	56,00	20,20	18,50
85	117,50	100,00	108,00	79,00	56,00	20,20	18,50
90	123,65	107,00	112,00	83,00	59,00	20,20	18,50
95	127,00	110,00	119,00	83,00	59,00	20,20	18,50
100	133,35	116,00	124,00	86,00	62,00	20,20	18,50

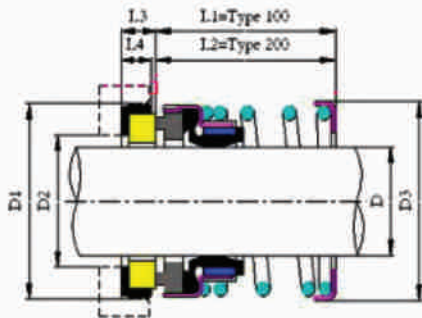

U2250

Equivalent to Eagle H1 Unit of Measure = Metric

D	D1	D2	D3	D4	D5	L1	L2	L3	L4	L5	L6	1-φ
20	34	35	29	42	36	46	13	5	2.0	23	18	3
22	36	37	31	44	38	46	13	5	2.0	23	18	3
24	38	39	33	46	40	48	13	5	2.0	23	18	3
25	39	40	34	47	41	48	13	5	2.0	23	18	3
28	42	43	37	50	44	50	13	5	2.0	23	18	3
30	44	45	39	52	46	50	13	5	2.0	23	18	3
32	46	48	42	54	48	50	13	5	2.0	23	18	3
33	47	48	42	55	49	50	13	5	2.0	23	18	3
35	49	50	44	57	51	54	13	5	2.0	23	20	3
38	54	56	50	64	58	57	13	5	2.0	25	20	4
40	56	58	52	66	60	59	13	5	2.0	25	20	4
42	58	-	-	68	62	59	-	-	-	25	20	-
43	59	61	55	69	63	59	13	5	2.0	25	20	4
45	61	63	57	71	65	59	13	5	2.0	25	20	4
48	64	66	60	74	68	59	13	5	2.0	25	20	4
50	66	68	62	76	70	62	13	5	2.0	25	20	4
52	68	-	-	78	72	63	-	-	-	25	20	-
53	69	71	65	79	73	63	13	5	2.0	25	20	4
55	71	73	67	91	75	63	13	5	2.0	25	20	4
58	76	79	70	89	83	66	16	7	2.5	28	22	4
60	78	81	72	91	85	66	16	7	2.5	28	22	-
62	80	-	-	93	87	66	-	-	-	28	22	4
63	81	84	75	94	88	66	16	7	2.5	28	22	4
65	84	86	77	96	90	70	16	7	2.5	28	22	4
68	87	90	81	99	93	70	16	7	2.5	30	24	4
70	90	92	83	101	95	71	16	7	2.5	30	24	4
75	95	97	88	110	104	75	16	7	2.5	30	24	4
80	100	105	96	115	109	75	16	7	2.5	31	25	4
85	107	110	101	120	114	80	16	7	2.5	31	25	4
90	112	115	106	125	119	80	16	7	2.5	31	25	4
95	119	120	111	130	124	85	16	7	2.5	31	25	4
100	124	125	116	135	129	85	16	7	2.5	31	25	4

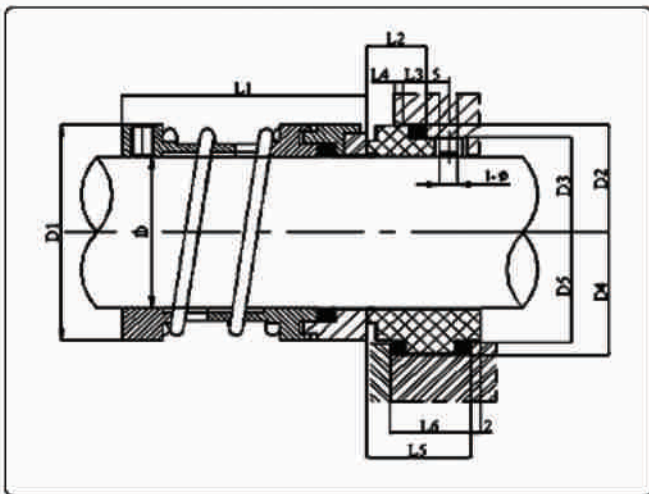

U2012

d	D	D1	L1	L2	L3	L4
10	20	21	15	27.5	35.0	5
12	22	23	15	26.5	34.0	6
14	24	25	15	29.0	34.0	6
15	25	26	15	29.0	34.0	6
16	26	27	15	29.0	34.0	6
18	32	33	20	31.5	39.0	6
20	34	35	20	31.5	39.0	6
22	36	37	20	31.5	39.0	6
24	38	39	20	34.0	44.0	6
25	39	40	20	34.0	44.0	6
28	42	43	26	36.5	44.0	6
30	44	45	26	35.5	43.0	7
32	46	48	26	35.5	48.0	7
33	47	48	26	35.5	48.0	7
35	49	50	26	34.5	47.0	8
38	54	56	30	37.0	47.0	8
40	56	58	30	37.0	47.0	8
43	59	61	30	37.0	52.0	8
45	61	63	30	37.0	52.0	8
48	64	66	30	35.0	50.0	10
50	66	70	30	37.5	50.0	10
53	69	73	30	37.5	60.0	10
55	71	75	30	37.5	60.0	10
58	78	78	33	42.5	60.0	10
60	80	80	33	40.5	58.0	12
63	83	83	33	40.5	58.0	12
65	85	85	33	40.5	68.0	12
68	88	90	33	40.5	68.0	12
70	90	92	33	48.0	68.0	12
75	99	97	40	48.0	68.0	12
80	104	105	40	47.5	77.5	14
85	109	110	40	47.5	77.5	14
90	114	115	40	52.5	77.5	14
95	119	120	40	52.5	77.5	14
100	124	125	40	52.5	77.5	14

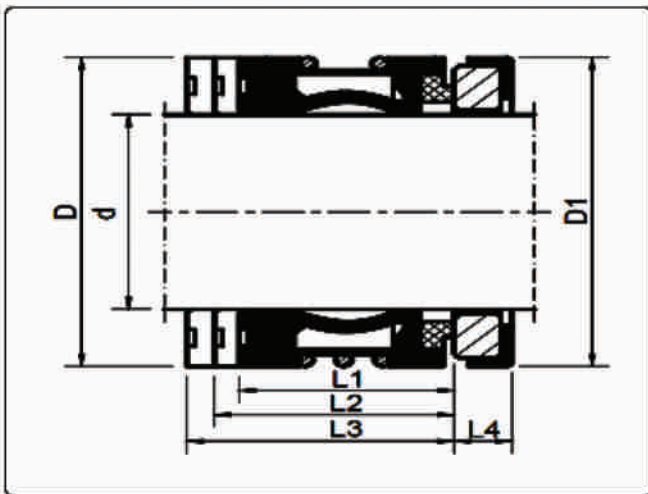

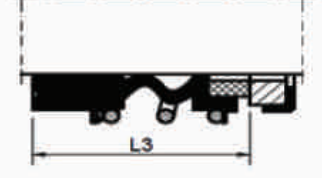
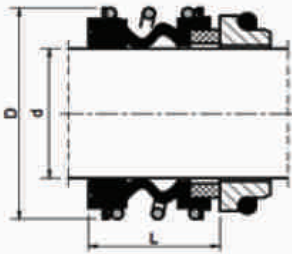

U2201

U2212

U2213

U2201S20

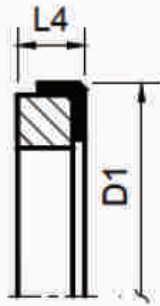

U60

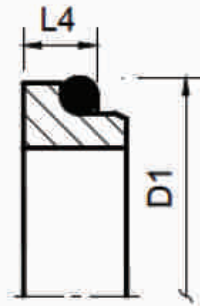

U6

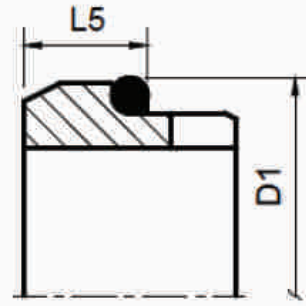

U9

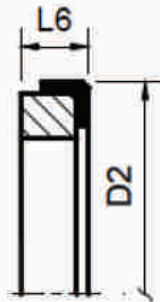

U50

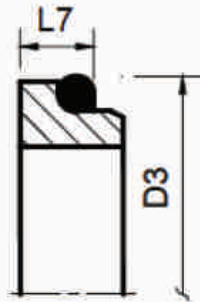

U4

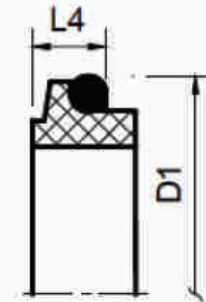

U606



U 2201, U2212, U2213, U2201S20 ÖLÇÜ TABLOSU

d	D	D1	D2	D3	L	L1	L2	L3	L4	L5	L6	L7
10	22.5	21	24.60	19.2	14.5	25.9	33.4	25.0	6.6	10.0	9.0	6.6
12	25.0	23	27.80	21.6	15.0	25.9	33.4	25.0	6.6	10.0	9.0	5.6
14	28.5	25	30.95	24.6	17.0	28.4	33.4	25.0	6.6	10.0	10.5	5.6
15	28.5	27	30.95	24.6	17.0	28.4	33.4	25.0	6.6	10.0	10.5	6.6
16	28.5	27	30.95	28.0	17.0	28.4	33.4	25.0	6.6	10.0	10.5	7.5
18	32.0	33	34.15	30.0	19.5	30.0	37.5	25.0	7.5	11.5	10.5	8.0
20	37.0	35	35.70	35.0	21.5	30.0	37.5	25.0	7.5	11.5	10.5	7.5
22	37.0	37	37.30	35.0	21.5	30.0	37.5	25.0	7.5	11.5	10.5	7.5
24	42.5	39	40.50	38.0	22.5	32.5	42.5	25.0	7.5	11.5	10.5	7.5
25	42.5	40	40.50	38.0	23.0	32.5	42.5	25.0	7.5	11.5	10.5	7.5
28	49.0	43	47.65	42.0	26.5	35.0	42.5	33.0	7.5	11.5	12.0	9.0
30	49.0	45	50.80	45.0	26.5	35.0	42.5	33.0	7.5	11.5	12.0	10.5
32	53.5	48	50.80	48.0	27.5	35.0	47.5	33.0	7.5	11.5	12.0	10.5
33	53.5	48	54.00	50.0	27.5	35.0	47.5	33.0	7.5	11.5	12.0	11.0
35	57.0	50	54.00	52.0	28.5	35.0	47.5	33.0	7.5	11.5	12.0	11.0
38	59.0	56	57.15	55.0	30.0	36.0	46.0	33.0	9.0	14.0	12.0	10.3
40	62.0	58	60.35	58.0	30.0	36.0	46.0	33.0	9.0	14.0	12.0	10.8
42	65.5	61	63.50	60.0	30.0	36.0	51.0	51.0	9.0	14.0	12.0	12.0
43	65.5	61	63.50	62.0	30.0	36.0	51.0	51.0	9.0	14.0	12.0	12.0
45	68.0	63	63.50	64.0	30.0	36.0	51.0	51.0	9.0	14.0	12.0	11.6
48	70.5	66	66.70	68.4	30.5	36.0	51.0	51.0	9.0	14.0	12.0	11.6
50	74.0	70	69.85	69.3	30.5	36.0	50.5	50.5	9.5	15.0	13.5	11.6
53	78.5	73	73.05	72.3	33.0	36.5	59.0	59.0	11.0	15.0	13.5	12.3
55	81.0	75	76.20	75.4	35.0	36.5	59.0	59.0	11.0	15.0	13.5	13.3
58	85.5	78	79.40	78.4	37.0	41.5	59.0	59.0	11.0	15.0	13.5	13.3
60	88.5	80	79.40	80.4	38.0	41.5	59.0	59.0	11.0	15.0	13.5	13.3
65	93.5	85	92.10	85.4	40.0	41.5	69.0	69.0	11.0	15.0	16.0	13.0
68	96.5	90	95.25	91.5	40.0	41.5	68.7	68.7	11.3	18.0	16.0	13.7
70	99.5	92	95.25	92.0	40.0	48.7	68.7	68.7	11.3	18.0	16.0	13.0
75	107.0	97	101.60	99.0	40.0	48.7	68.7	68.7	11.3	18.0	16.0	14.0
80	112.0	105	114.30	104.0	40.0	48.0	78.0	78.0	12.0	18.2	20.0	15.0
85	120.0	110	117.50	109.0	41.0	46.0	76.0	76.0	14.0	18.2	20.0	14.8
90	127.0	115	123.85	114.0	45.0	51.0	76.0	76.0	14.0	18.2	20.0	14.8
95	132.0	120	127.00	120.3	46.0	51.0	76.0	76.0	14.0	17.2	20.0	15.8
100	137.0	125	133.35	123.3	47.0	51.0	76.0	76.0	14.0	17.2	20.0	15.8

Dimensions in mm.

U2301
U2301 SERIES FOR GRUNDFOS PUMP SEAL.

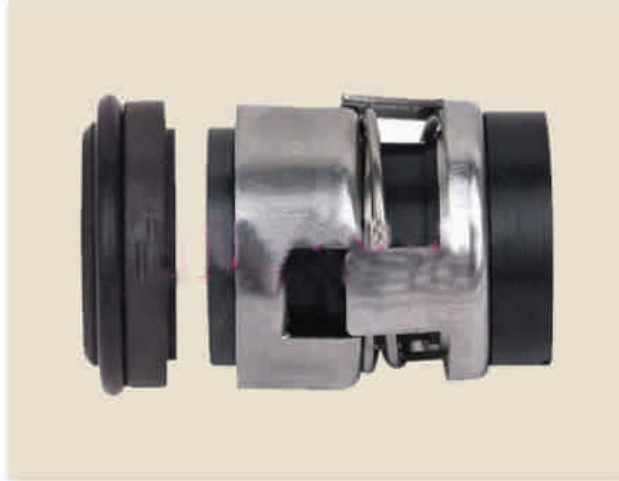

Metric Shaft D	Size Code	D1	D2	D3	L1	L2	L3
12	120	22	19	23	40.5	39.0	31
16	160	26	23	27	41.5	40.5	32.5

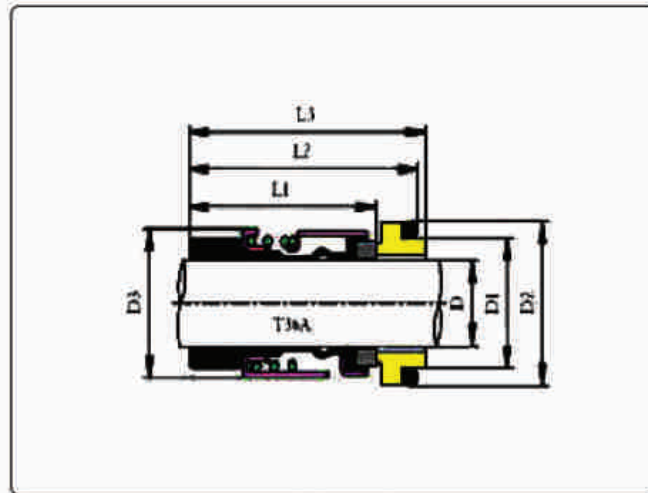

U2070K

Inch Shaft Size d	Metric Shaft Size d	D1	D	L	L1
0,625	16	28,50	27,00	19,10	6,30
0,750		31,70	30,00	19,10	6,30
	24	35,40	34,10	19,10	7,60
	28	42,00	39,00	19,10	7,60
1,125		41,20	39,50	19,10	7,60
	30	42,70	41,00	19,10	7,60
1,250		44,40	42,40	19,10	7,60
	32	44,40	42,40	19,10	7,60
1,375	35	47,60	45,50	19,10	7,60
1,500	38	53,90	51,80	21,10	8,10
1,750		60,30	58,20	21,10	8,10
1,875		63,50	61,40	21,10	8,10
	50	63,90	61,90	21,10	8,10
2,000		66,60	64,60	22,10	9,60
2,125		73,00	71,00	22,10	9,60
	54	73,90	71,00	22,10	9,60
2,150	55	75,00	72,00	22,10	9,60
	63	83,00	79,30	25,80	9,10
2,500		88,90	79,30	25,80	9,10
2,750		95,20	90,80	25,80	9,10
2,875	73	98,40	94,00	25,80	9,10
	75	100,40	96,00	25,80	9,10
3,000		101,60	96,90	25,80	9,10
	80	104,00	101,00	25,80	9,10
	95	125,00	116,00	25,80	9,10
	100	130,00	121,00	25,80	9,10

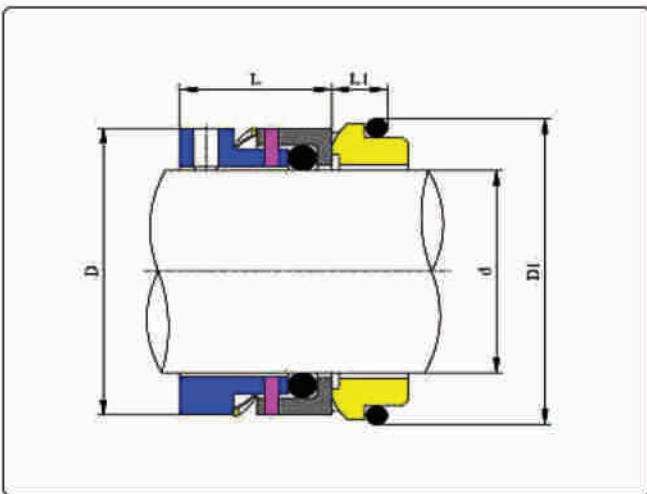

U2090

Metric Shaft Size d	Inch Shaft Size d	Seat Size	D1	D2	D3	D4	L6	L10	T
16	0,750	0190	54	36,51	37,5	48	4,8	8	0,8
18	0,750	0190	54	36,51	37,5	48	4,8	8	0,8
20	0,875	0222	57	39,69	40,5	51	4,8	8	0,8
22	0,875	0222	57	39,69	40,5	51	4,8	8	0,8
24	1,000	0254	61	42,86	43,5	54	4,8	8	0,8
25	1,000	0254	61	42,86	43,5	54	4,8	8	0,8
28	1,125	0317	67	50,80	51,5	55	8,0	11	1,6
30	1,250	0349	70	53,98	55,0	68	8,0	11	1,6
32	1,250	0349	70	53,98	55,0	68	8,0	11	1,6
33	1,375	0381	73	57,15	58,0	71	8,0	11	1,6
35	1,375	0381	73	57,15	58,0	71	8,0	11	1,6
38	1,500	0412	76	63,50	64,5	78	8,0	11	1,6
40	1,625	0444	80	66,68	67,5	81	8,0	11	1,6
43	1,750	0476	83	69,85	71,0	84	8,0	11	1,6
45	1,750	0476	83	69,85	71,0	84	8,0	11	1,6
-	1,875	0508	86	73,03	74,0	87	8,0	11	1,6
48	2,000	0539	89	79,38	80,0	97	9,5	14	1,6
50	2,000	0539	89	79,38	80,0	97	9,5	14	1,6
53	2,125	0571	103	82,55	83,5	100	9,5	14	1,6
55	2,250	0603	107	85,73	86,5	103	9,5	14	1,6
58	2,375	0635	110	88,90	89,5	106	9,5	14	1,6
60	2,375	0635	110	88,90	89,5	106	9,5	14	1,6

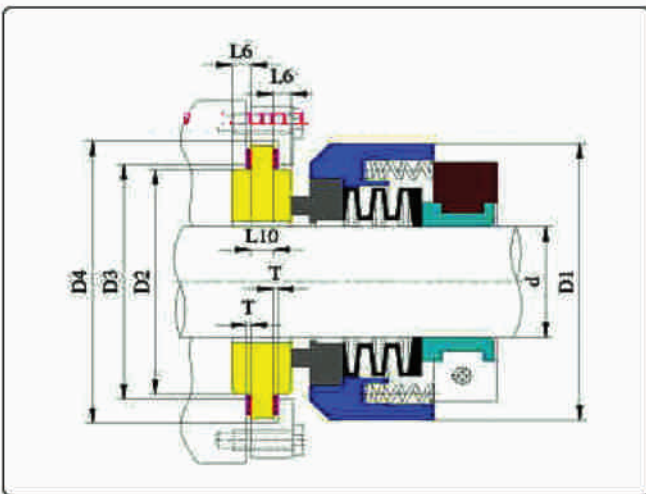

U2092

Equivalent to Burgmann HJ92 Unit of Measure = Metric

D1	D3	Dm	L3	L13	f
18	32	29	30.5	28.5	3.0
20	34	33	30.5	28.5	3.0
22	36	35	30.5	28.5	3.0
24	38	37	33.0	31.0	3.5
25	39	38	33.0	31.0	3.5
28	42	39	35.5	33.0	3.5
30	44	41	35.5	33.0	3.5
32	47	45	35.5	33.0	3.5
33	47	46	35.5	33.0	3.5
35	49	48	35.5	33.0	3.5
38	54	53	37.0	34.5	4.0
40	56	55	37.0	34.5	4.0
43	59	58	37.0	34.5	4.0
45	61	60	37.0	34.5	4.0
48	64	63	37.0	34.5	4.0
50	66	65	38.0	35.5	4.5
53	69	68	38.0	35.5	4.5
55	71	70	38.0	35.5	4.5
58	78	77	42.0	39.5	4.5
60	80	73	42.0	39.5	4.5
63	83	76	42.0	39.5	4.5
65	85	84	42.0	39.5	4.5
68	88	87	41.5	39.0	4.5
70	90	89	48.5	46.0	5.0
75	99	97	48.5	46.0	5.5
80	104	95	48.5	46.0	5.5
85	109	100	48.5	46.0	5.5
90	114	105	52.0	49.5	5.5
95	119	110	52.0	49.5	5.5
100	124	115	52.0	49.5	5.5

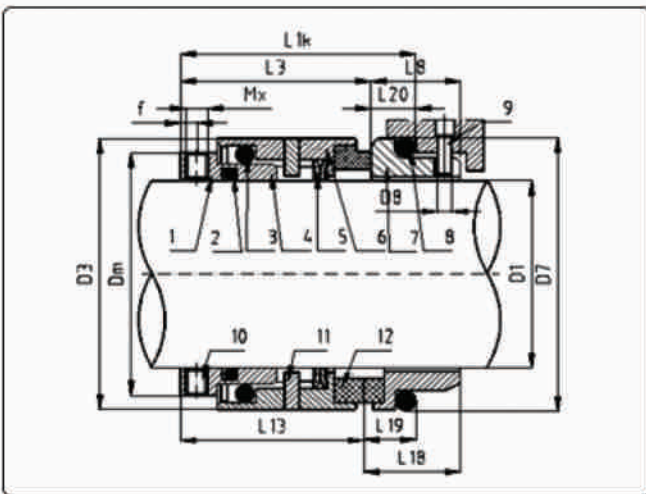

U2207

Equivalent to Burgmann M7N Unit of Measure = Metric

D1	D3	L1k	L3	f	Mx
14	25	35.0	25.0	6	M5
16	27	35.0	25.0	6	M5
18	33	37.5	26.0	7	M5
20	35	37.5	26.0	7	M5
22	37	37.5	26.0	7	M5
24	39	40.0	28.5	8	M5
25	40	40.0	28.5	8	M5
28	43	42.5	31.0	8	M6
30	45	42.5	31.0	8	M6
32	47	42.5	31.0	8	M6
33	48	42.5	31.0	8	M6
35	50	42.5	31.0	8	M6
38	55	45.0	31.0	8	M6
40	57	45.0	31.0	8	M6
43	60	45.0	31.0	8	M6
45	62	45.0	31.0	8	M6
48	65	45.0	31.0	8	M6
50	67	47.5	32.5	8	M6
53	70	47.5	32.5	8	M6
55	72	47.5	32.5	8	M6
58	79	52.5	37.5	9	M8
60	81	52.5	37.5	9	M8
63	84	52.5	37.5	9	M8
65	86	52.5	37.5	9	M8
68	89	52.5	34.5	9	M8
70	91	60.0	42.0	9	M8
75	99	60.0	42.0	10	M8
80	104	60.0	41.8	10	M8
85	109	60.0	41.8	10	M8
90	114	65.0	46.8	10	M8
95	119	65.0	47.8	10	M8
100	124	65.0	47.8	10	M8

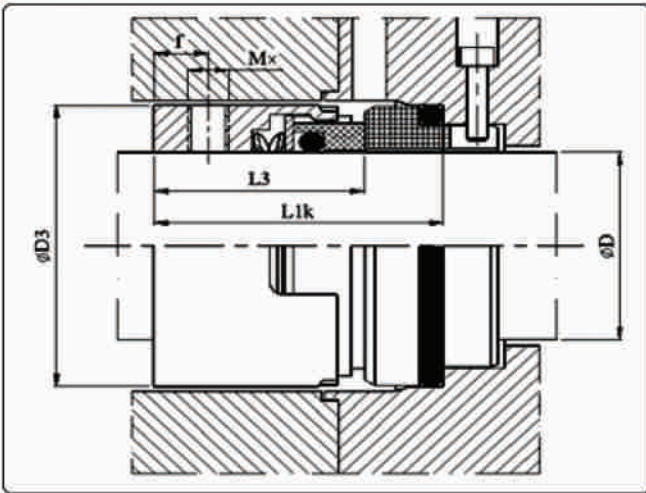

U2208

Equivalent to John Crane 8-1 Unit of Measure = Metric

D1	D3	D4	L1k	L3
14	24	25	35.0	23.0
16	26	27	35.0	23.0
18	32	33	37.5	24.0
20	34	35	37.5	24.0
22	36	37	37.5	24.0
24	38	39	40.0	26.7
25	39	40	40.0	27.0
28	42	43	42.5	30.0
30	44	45	42.5	30.5
32	46	48	42.5	30.5
33	47	48	42.5	30.5
35	49	50	42.5	30.5
38	54	56	45.0	32.0
40	56	58	45.0	32.0
43	59	61	45.0	32.0
45	61	63	45.0	32.0
48	64	66	45.0	32.0
50	66	70	47.5	34.0
53	69	73	47.5	34.0
55	71	75	47.5	34.0
58	78	78	52.5	39.0
60	80	80	52.5	39.0
63	83	83	52.5	39.0
65	85	85	52.5	39.0
68	88	90	52.5	39.0
70	90	92	60.0	45.5
75	95	97	60.0	45.5
80	104	105	60.0	45.0
85	109	110	60.0	45.0
90	114	115	65.0	50.0
95	119	120	65.0	50.0
100	124	125	65.0	50.0

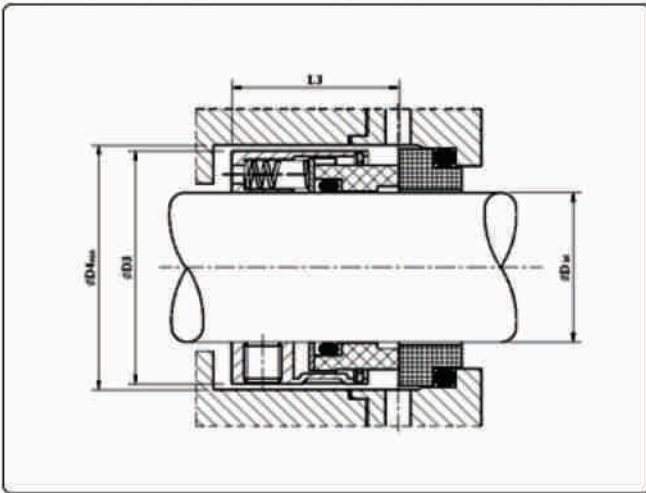

U2209

Equivalent to John Crane 9 Unit of Measure = Metric

D1	D3	D4	L1k	L3
14	24	25	35.0	23.0
16	26	27	35.0	23.0
18	32	33	37.5	24.0
20	34	35	37.5	24.0
22	36	37	37.5	24.0
24	38	39	40.0	26.7
25	39	40	40.0	27.0
28	42	43	42.5	30.0
30	44	45	42.5	30.5
32	46	48	42.5	30.5
33	47	48	42.5	30.5
35	49	50	42.5	30.5
38	54	56	45.0	32.0
40	56	58	45.0	32.0
43	59	61	45.0	32.0
45	61	63	45.0	32.0
48	64	66	45.0	32.0
50	66	70	47.5	34.0
53	69	73	47.5	34.0
55	71	75	47.5	34.0
58	78	78	52.5	39.0
60	80	80	52.5	39.0
63	83	83	52.5	39.0
65	85	85	52.5	39.0
68	88	90	52.5	39.0
70	90	92	60.0	45.5
75	95	97	60.0	45.5
80	104	105	60.0	45.0
85	109	110	60.0	45.0
90	114	115	65.0	50.0
95	119	120	65.0	50.0
100	124	125	65.0	50.0

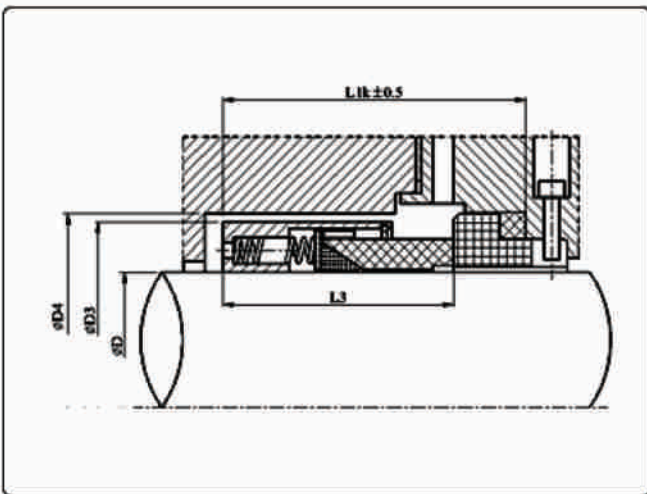

U2891

Equivalent to Chesterton 891 Unit of Measure = Metric

Size	D3	L3	M	f
18	33	32	M4	3.0
20	35	32	M4	3.0
22	37	32	M4	3.0
24	39	32	M5	3.5
25	40	32	M5	3.5
28	43	32	M5	3.5
30	45	32	M5	3.5
32	47	42	M5	3.5
33	48	42	M5	3.5
35	50	42	M5	3.5
38	55	42	M5	4.0
40	57	42	M5	4.0
43	60	42	M5	4.0
45	62	42	M5	4.0
48	65	42	M5	4.0
50	67	42	M6	4.5
53	70	42	M6	4.5
55	72	42	M6	4.5
58	79	42	M6	4.5
60	81	42	M6	4.5
63	84	42	M6	4.5
65	86	42	M6	4.5
68	89	42	M6	4.5
70	91	42	M6	5.0
75	99	48	M8	5.5
80	104	48	M8	5.5
85	109	48	M8	5.5
90	114	48	M8	5.5
95	119	48	M8	5.5
100	124	48	M8	5.5

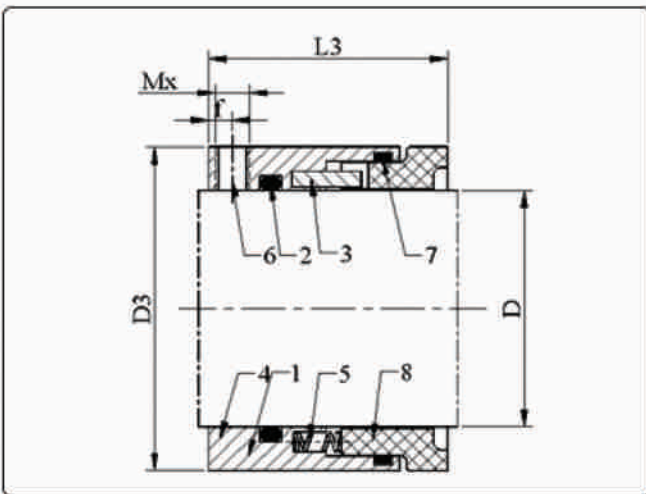

U6

Equivalent to Burgmann G6 Unit of Measure = Metric

Shaft	d6	d7	L10	L28
10	17	21	7.5	6.6
12	19	23	7.5	6.6
14	21	25	7.5	6.6
16	23	27	7.5	6.6
18	27	33	8.5	7.5
20	29	35	8.5	7.5
22	31	37	8.5	7.5
24	33	39	8.5	7.5
25	34	40	8.5	7.5
28	37	43	8.5	7.5
30	39	45	8.5	7.5
32	42	48	8.5	7.5
33	42	48	8.5	7.5
35	44	50	8.5	7.5
38	49	56	10.0	9.0
40	51	58	10.0	9.0
43	54	61	10.0	9.0
45	56	63	10.0	9.0
48	59	66	10.0	9.0
50	62	70	10.5	9.5
53	65	73	12.0	11.0
55	67	75	12.0	11.0
58	70	78	12.0	11.0
60	72	80	12.0	11.0
65	77	85	12.0	11.0
68	81	90	12.5	11.3
70	83	92	12.5	11.3
75	88	97	12.5	11.3
80	95	105	13.0	12.0
85	100	110	15.0	14.0
90	105	115	15.0	14.0
95	110	120	15.0	14.0
100	115	125	15.0	14.0

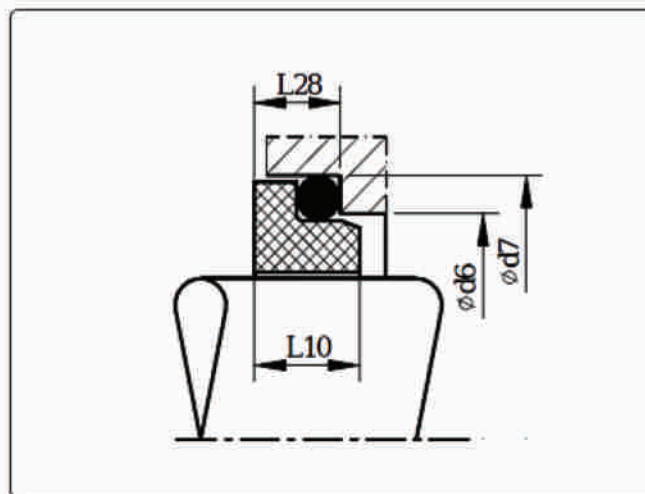

U9

Equivalent to John Crane G9 Unit of Measure = Metric

Shaft	d6	d7	d8	L5	L8	L20
10	17	21	3	5	17.5	10.0
12	19	23	3	5	17.5	10.0
14	21	25	3	5	17.5	10.0
16	23	27	3	5	17.5	10.0
18	27	33	3	5	19.5	11.5
20	29	35	3	5	19.5	11.5
22	31	37	3	5	19.5	11.5
24	33	39	3	5	19.5	11.5
25	34	40	3	5	19.5	11.5
28	37	43	3	5	19.5	11.5
30	39	45	3	5	19.5	11.5
32	42	48	3	5	19.5	11.5
33	42	48	3	5	19.5	11.5
35	44	50	3	5	19.5	11.5
38	49	56	4	5	22.0	14.0
40	51	58	4	5	22.0	14.0
43	54	61	4	5	22.0	14.0
45	56	63	4	5	22.0	14.0
48	59	66	4	5	22.0	14.0
50	62	70	4	5	23.0	15.0
53	65	73	4	5	23.0	15.0
55	67	75	4	5	23.0	15.0
58	70	78	4	5	23.0	15.0
60	72	80	4	5	23.0	15.0
65	77	85	4	5	23.0	15.0
68	81	90	4	5	26.0	18.0
70	83	92	4	5	26.0	18.0
75	88	97	4	5	26.0	18.0
80	95	105	4	5	26.2	18.2
85	100	110	4	5	26.2	18.2
90	105	115	4	5	26.2	18.2
95	110	120	4	5	25.2	17.2
100	115	125	4	5	25.2	17.2

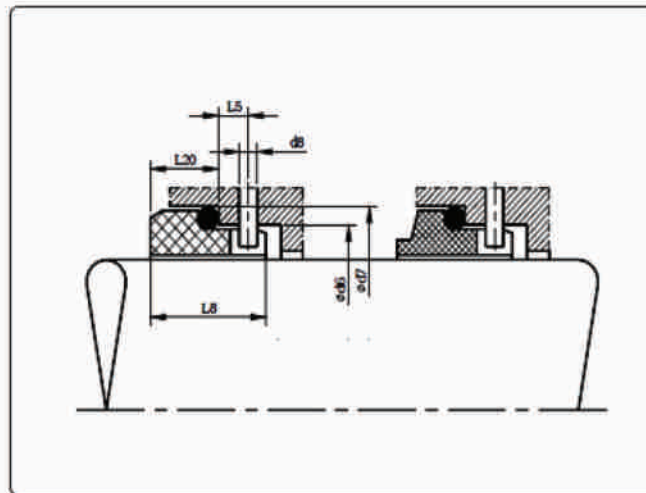

U13

Equivalent to Burgmann G13 Unit of Measure = Metric

Shaft	d11	d12	L11	L13	L15	L16
10	15.5	19.2	9.0	7.1	1.2	3.8
12	17.5	21.6	10.0	7.6	1.2	3.8
14	20.5	24.6	10.0	7.6	1.2	3.8
15	20.5	24.6	11.0	8.6	1.2	3.8
16	22.0	28.0	11.5	9.0	1.5	5.0
18	24.0	30.0	12.5	10.0	1.5	5.0
20	29.5	35.0	12.5	9.5	1.5	5.0
22	29.5	35.0	12.5	9.5	1.5	5.0
24	32.0	38.0	12.5	9.5	1.5	5.0
25	32.0	38.0	12.5	9.5	1.5	5.0
28	36.0	42.0	14.0	11.0	1.5	5.0
30	39.2	45.0	14.0	11.0	1.5	5.0
32	42.2	48.0	14.0	11.0	1.5	5.0
33	44.2	50.0	14.5	11.5	1.5	5.0
35	46.2	52.0	14.5	11.5	1.5	5.0
38	49.2	55.0	14.5	11.5	1.5	5.0
40	52.2	58.0	14.5	11.5	1.5	5.0
42	53.3	62.0	17.0	14.3	2.0	6.0
43	53.3	62.0	17.0	14.3	2.0	6.0
45	55.3	64.0	17.0	14.3	2.0	6.0
48	59.7	68.4	17.0	14.3	2.0	6.0
50	80.8	69.3	17.0	14.3	2.0	6.0
53	63.8	72.3	17.0	14.3	2.0	6.0
55	66.5	75.4	18.0	15.3	2.0	6.0
58	69.5	78.4	18.0	15.3	2.0	6.0
60	71.5	80.4	18.0	15.3	2.0	6.0
63	74.5	83.4	18.0	15.3	2.0	6.0
65	76.5	85.4	18.0	15.3	2.0	6.0
68	82.7	91.5	19.0	16.0	2.0	6.0
70	83.0	92.0	18.0	15.3	2.0	6.0
75	90.2	99.0	18.0	15.3	2.0	6.0
80	95.2	104.0	19.0	16.3	2.0	6.0
85	100.2	109.0	19.0	16.3	2.0	6.0
90	105.2	114.0	19.0	16.3	2.0	6.0
95	111.6	120.3	20.0	17.3	2.0	6.0
100	114.5	123.3	20.0	17.3	2.0	6.0

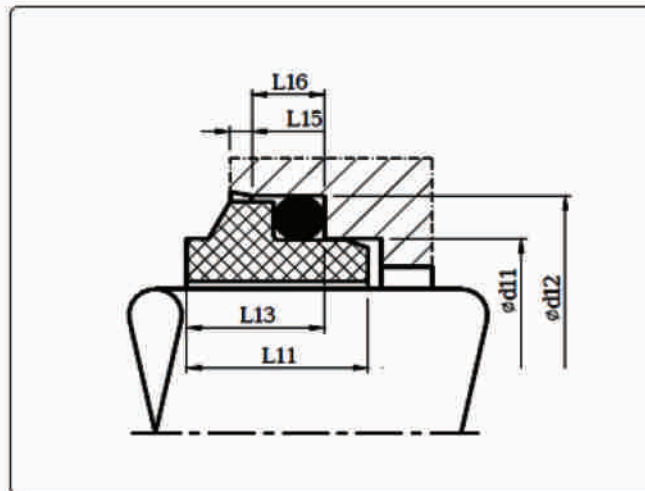

U60

Equivalent to Burgmann G60 Unit of Measure = Metric

Shaft	d6	d7	L28
10	17	21	6.6
12	19	23	6.6
14	21	25	6.6
16	23	27	6.6
18	27	33	7.5
20	29	35	7.5
22	31	37	7.5
24	33	39	7.5
25	34	40	7.5
28	37	43	7.5
30	39	45	7.5
32	42	48	7.5
33	42	48	7.5
35	44	50	7.5
38	49	56	9.0
40	51	58	9.0
43	54	61	9.0
45	56	63	9.0
48	59	66	9.0
50	62	70	9.5
53	65	73	11.0
55	67	75	11.0
58	70	78	11.0
60	72	80	11.0
65	77	85	11.0
68	81	90	11.3
70	83	92	11.3
75	88	97	11.3
80	95	105	12.0
85	100	110	14.0
90	105	115	14.0
95	110	120	14.0
100	115	125	14.0

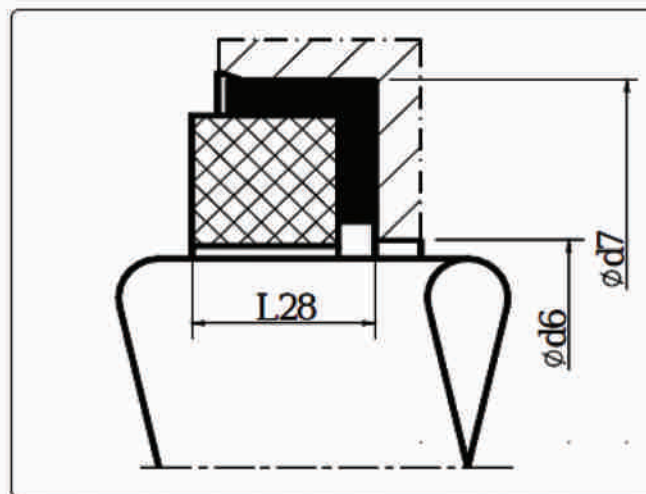

UDINL

Equivalent to UDINL Unit of Measure = Metric

Shaft	d6	d7	d8	L5	L6	L8	L9
10	17	21	3	1.5	5.5	15.0	8.6
12	19	23	3	1.5	5.5	15.0	8.6
14	21	25	3	1.5	5.5	15.0	8.6
16	23	27	3	1.5	5.5	15.0	8.6
18	27	33	3	2.0	7.0	17.0	10.0
20	29	35	3	2.0	7.0	17.0	10.0
22	31	37	3	2.0	7.0	17.0	10.0
24	33	39	3	2.0	7.0	17.0	10.0
25	34	40	3	2.0	7.0	17.0	10.0
28	37	43	3	2.0	7.0	17.0	10.0
30	39	45	3	2.0	7.0	17.0	10.0
32	42	48	3	2.0	7.0	17.0	10.0
33	42	48	3	2.0	7.0	17.0	10.0
35	44	50	3	2.0	7.0	17.0	10.0
38	49	56	4	2.0	8.0	18.0	11.0
40	51	58	4	2.0	8.0	18.0	11.0
43	54	61	4	2.0	8.0	18.0	11.0
45	56	63	4	2.0	8.0	18.0	11.0
48	59	66	4	2.0	8.0	18.0	11.0
50	62	70	4	2.5	8.5	20.0	13.0
53	65	73	4	2.5	8.5	20.0	13.0
55	67	75	4	2.5	8.5	20.0	13.0
58	70	78	4	2.5	8.5	20.0	13.0
60	72	80	4	2.5	8.5	20.0	13.0
65	77	85	4	2.5	8.5	20.0	13.0
68	81	90	4	2.5	9.5	22.0	15.3
70	83	92	4	2.5	9.5	22.0	15.3
75	88	97	4	2.5	9.5	22.0	15.3
80	95	105	4	3.0	10.0	22.5	15.7
85	100	110	4	3.0	10.0	22.5	15.7
90	105	115	4	3.0	10.0	22.5	15.7
95	110	120	4	3.0	10.0	22.5	15.7
100	115	125	4	3.0	10.0	22.5	15.7

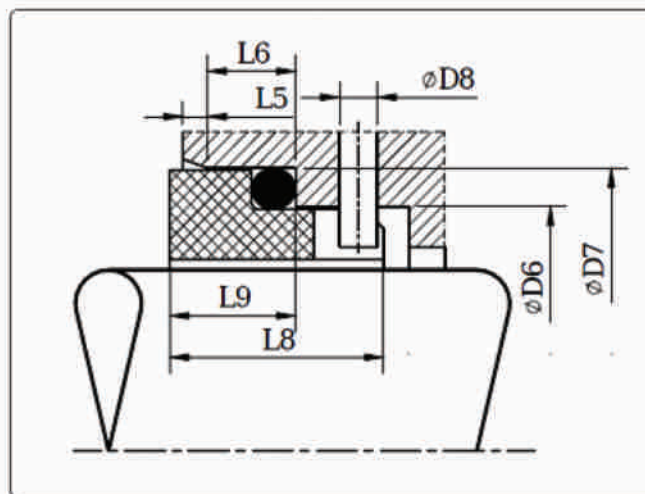

UDINS

Equivalent to UDINS Unit of Measure = Metric

Shaft	d6	d7	L5	L6	L9	L10
10	17	21	1.5	5.5	8.6	10.0
12	19	23	1.5	5.5	8.6	10.0
14	21	25	1.5	5.5	8.6	10.0
16	23	27	1.5	5.5	8.6	10.0
18	27	33	2.0	7.0	10.0	11.5
20	29	35	2.0	7.0	10.0	11.5
22	31	37	2.0	7.0	10.0	11.5
24	33	39	2.0	7.0	10.0	11.5
25	34	40	2.0	7.0	10.0	11.5
28	37	43	2.0	7.0	10.0	11.5
30	39	45	2.0	7.0	10.0	11.5
32	42	48	2.0	7.0	10.0	11.5
33	42	48	2.0	7.0	10.0	11.5
35	44	50	2.0	7.0	10.0	11.5
38	49	56	2.0	8.0	11.0	12.5
40	51	58	2.0	8.0	11.0	12.5
43	54	61	2.0	8.0	11.0	12.5
45	56	63	2.0	8.0	11.0	12.5
48	59	66	2.0	8.0	11.0	12.5
50	62	70	2.5	8.5	13.0	14.5
53	65	73	2.5	8.5	13.0	14.5
55	67	75	2.5	8.5	13.0	14.5
58	70	78	2.5	8.5	13.0	14.5
60	72	80	2.5	8.5	13.0	14.5
65	77	85	2.5	8.5	13.0	14.5
68	81	90	2.5	9.5	15.3	16.5
70	83	92	2.5	9.5	15.3	16.5
75	88	97	2.5	9.5	15.3	16.5
80	95	105	3.0	10.0	15.7	17.5
85	100	110	3.0	10.0	15.7	17.5
90	105	115	3.0	10.0	15.7	17.5
95	110	120	3.0	10.0	15.7	17.5
100	115	125	3.0	10.0	15.7	17.5

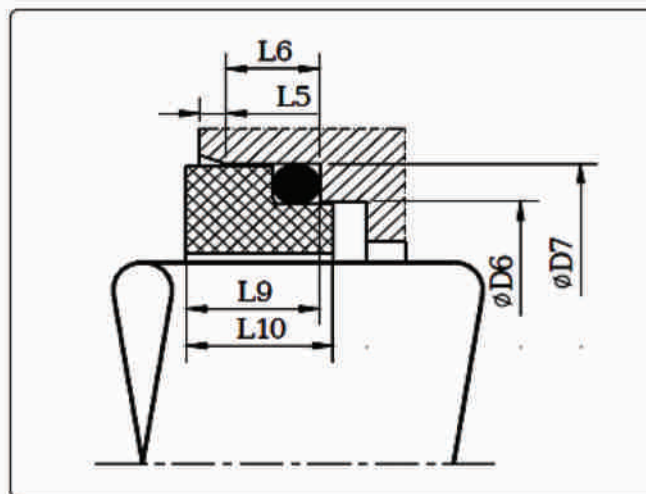

FRISTAM POMPA MUADİL SALMASTRALARI:



U2031

(İçten Çalışan Döner Eleman)



U2032

(Dıştan Çalışan Döner Eleman)



U2031L

(İçten Çalışan Uzun Kuyruk Sabit Eleman)



U2031S

(Dıştan çalışan Kısa Kuyruk Sabit Eleman)



U2033

(İçten Çalışan Uzun Körüklü Döner Eleman)



U2034

(Dıştan Çalışan Kısa Körüklü Döner Eleman)



U2035

(Dıştan Çalışan Boğazı Yaylı Döner Eleman)



U2031C

(İçten Çalışan Karbon Burç)

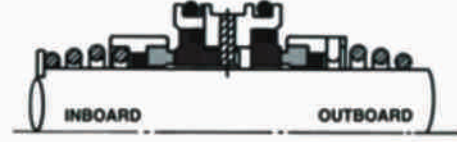
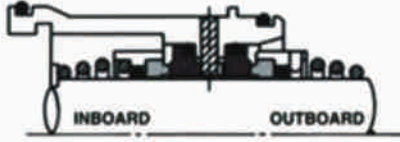

FRİSTAM POMPA SALMASTRASININ KOVAN İÇERİSİNDEKİ MONTAJ ŞEKİLLERİ

FRİSTAM KOVAN TİPLERİ:



U2036K



U3037K



U2038K



U2039K



FL-FLF-FLFN LOBE POMPA SERİSİ

MALZEMELER:

İçten ve dıştan çalışan döner eleman : Karbon, Silisyum Karbür, Tungsten Karbür

İçten ve dıştan çalışan sabit eleman : 316 Paslanmaz, Silisyum Karbür, Seramik, Tungsten Karbür

Yay : Krom Oksit kaplama

Metal kısımlar : 316 Paslanmaz

Elastomer : Nitril, Viton, EPDM

ALFA LAVAL POMPA MUADİL SALMASTRALARI:



U2040 (32 mm LKH SERİSİ)



U2041

(ALC SERİSİ SALMASTRASI)



U2047

(SRU LOBE SERİSİ)

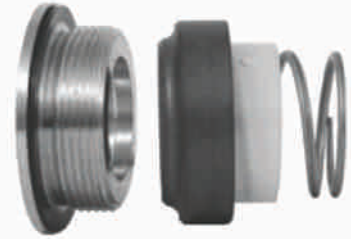

U2042

(27 mm çaplı MR serisi)



U2043

(22mm çaplı CM ve EM SERİSİ)



U2044

(22 mm FM serisi)



U2045

(22 mm GM ve ME SERİSİ)

MALZEMELER:

Döner eleman : Karbon, Silisyum Karbür, Tungsten Karbür

Sabit eleman : Paslanmaz, Silisyum Karbür, Tungsten Karbür

Elastomer : Nitril, Viton, EPDM

Metal kısımlar : 304 ve 316 Paslanmaz

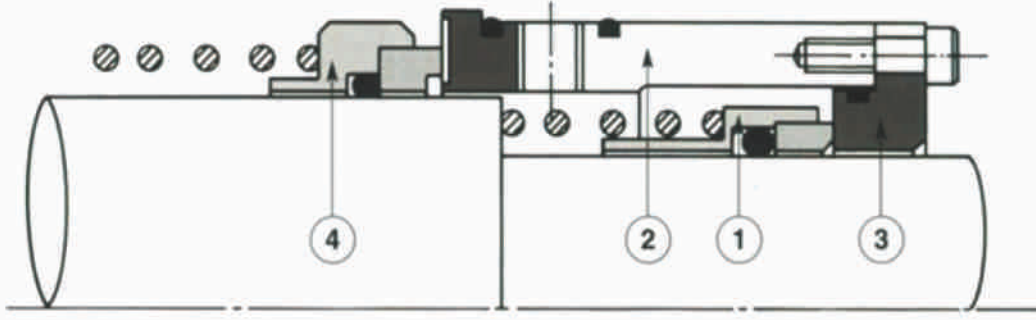

U2047

Contherm Buhar Bariyeri Salmastrası



1. 1 1/2" İçten Çalışan Döner Eleman
4. 2" Dıştan Çalışan Döner Eleman



2. Dıştan Çalışan Sabit Eleman



3. İçten Çalışan Sabit Eleman

MALZEMELER:

İçten çalışan döner eleman(1) : Karbon, Tungsten Karbür

Dıştan çalışan döner eleman(4) : Karbon, Tungsten Karbür

Dıştan çalışan sabit eleman(2) : Seramik, Krom Oksit kaplama

İçten çalışan sabit eleman(3) : Seramik, Krom Oksit kaplama

Metal kısımlar : 316 Paslanmaz

APV POMPA MUADİL SALMASTRALARI:



U2051

25 ve 35 mm APV W+ SERİSİ



U2052

25 ve 35 mm ÇAPLI APV W SERİSİ POMPA SALMASTRALARI



U2053

20, 25 ve 30 mm APV ROSİSTA
ve PASİLAC SERİSİ



U2054

48 mm APV ZMS-5 SERİSİ

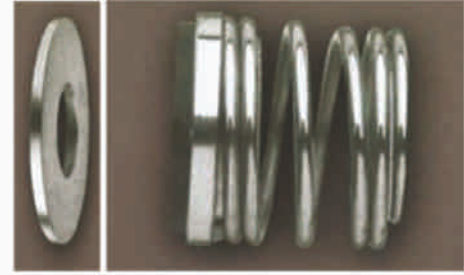

U2055

1" ve 1^{1/2}" APV PUMA SERİSİ



U2056

APV ZMK SERİSİ



U2057

APV CREPACO V SERİSİ



U2058

APV LOBE DW SERİSİ

WAUKESHA LOBE POMPA MUADİL MEKANİK SALMASTRALARI:



U2060

WAUKESHA Lobe 018UL, 030UL, 045UL, 050UL, 060UL, 130UL, 220UL, 224UL, 320 UL Serisi
Pompalarda Kullanılan Single ve Double Salmastraları

INOXPA POMPA MUADİL SALMASTRALARI:

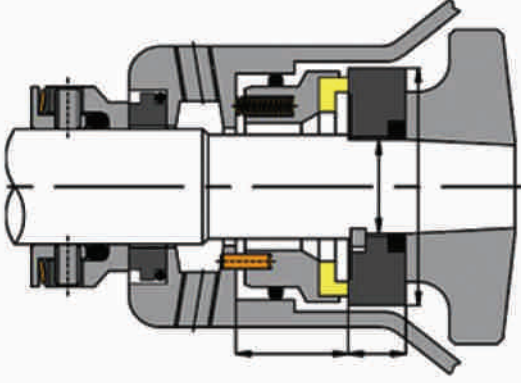

INOXPA PROLAC DOUBLE SALMASTRA

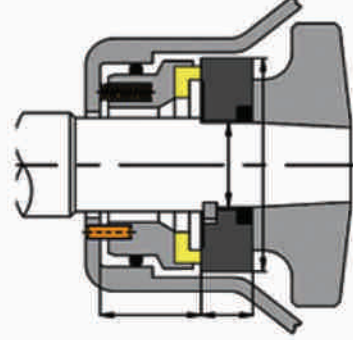

INOXPA PROLAC SINGLE SALMASTRA



U2065

INOXPA PROLAC Serisinde Kullanılan Mekanik Salmastralar
(Çaplar: 0.625" ile 1.500" arası)



U2067

INOXPA SLR SERİSİ LOBE POMPA SALMASTRASI
(Çaplar: 28 mm, 35 mm, 50 mm, 65 mm)

JOHNSON LOBE POMPA MUADİL SALMASTRALARI:

JOHNSON W SERİSİ: **U2071**

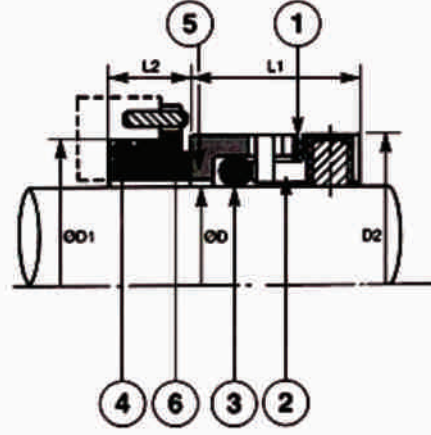

Metric Shaft Size D	Size Code	D1	D2	L1	L2
20	0200	30.00	31.00	19.10	10.70
30	0300	41.00	41.00	19.10	10.90
35	0350	47.00	45.50	21.10	12.20
45	0450	58.00	58.20	21.10	11.60
55	0550	70.00	72.00	22.10	13.00
75	0750	92.00	96.00	25.80	14.50

- 1 : Yay
- 2 : Baskı bileziği
- 3-4 : O-ring
- 5 : Döner eleman
- 6 : Sabit Eleman

JOHNSON Y SERİSİ: **U2072**

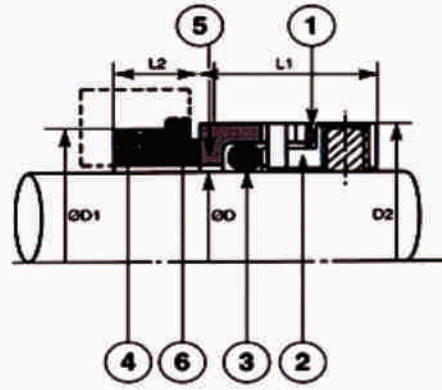

Metric Shaft Size D	Size Code	D1	D2	L1	L2
30	0300	40.00	41.00	19.10	9.30
35	0350	44.50	45.50	21.10	9.20
50	0500	62.00	61.90	21.10	10.40
70	0700	85.00	88.90	25.80	14.10
80	0800	95.00	101.00	25.80	16.20

- 1 : Yay
- 2 : Baskı bileziği
- 3-4 : O-ring
- 5 : Döner eleman
- 6 : Sabit Eleman

JOHNSON TOPLOBE SERİSİ: U2077

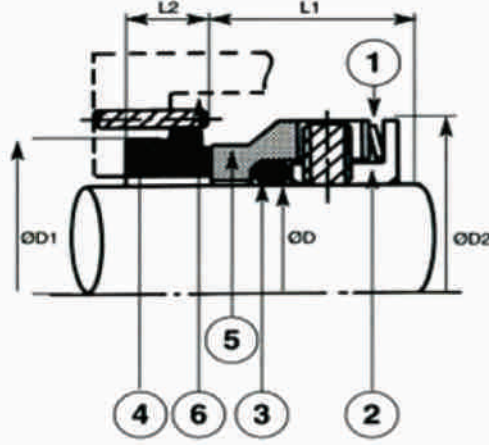

Metric Shaft Size D	Size Code	D1	D2	L1	L2
20	0200	30.00	32.40	20.00	10.50
30	0300	41.30	44.00	21.40	11.10
35	0350	46.95	50.80	22.00	12.00
45	0450	58.26	62.40	22.90	12.60
55	0550	69.55	76.00	29.30	13.20
75	0750	92.15	99.20	31.10	14.40

- 1 : Yay
- 2 : Baskı bileziği
- 3-4 : O-ring
- 5 : Döner eleman
- 6 : Sabit Eleman

HİLGE POMPA MUADİL SALMASTRALARI:



U2092H-1



U2092H-2



U2092H-3

28 mm ve 38 mm çaplarında Hilge pompa muadil salmastraları

ÖRGÜ SALMASTRALAR

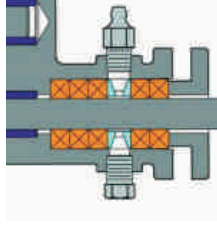

TYPE 4100 (SAF TEFLON)

Saf teflon ipliklerden imal edilmiş olup, vana ve düşük devirli pompalar için idealdir. Kimyasal aşındırıcılara karşı dayanımı oldukça iyidir. Gıda, ilaç ve kağıt endüstrisinde kullanılmaktadır.

Sıcaklık	: -150 - +260 C
pH	: 0-14
Hız	: 2 m/s
Basınç	: 150 bar



TYPE 4110 (YAĞ EMPRENYELİ SAF TEFLON)

Saf teflona özel bir yağ emrenye edilerek sürtünmeden oluşan aşımalar azaltılmış ve daha dinamik bir yapı kazandırılmıştır. Bu salmastra gıdaya uygun değildir.

Sıcaklık	: -150 - +260 C
pH	: 0-14
Hız	: 10 m/s
Basınç	: 200 bar



TYPE 4120 (SYNTEX TEFLON)

Özel bir filament ipliğe örgü işleminden önce ve sonra teflon empenye edilerek dayanımının artması sağlanmıştır. Böylelikle kopma ve parçalanmaya karşı direnci artırılmıştır.

Sıcaklık	: -150 - +260 C
pH	: 0-14
Hız	: 10 m/s
Basınç	: 250 bar



ÖLÇÜLER:

Size mm	4	5	6	8	10	12	14	15	16	18	19	20
appr. m/kg	35	22	16	9.0	5.6	3.9	2.9	2.5	2.2	1.7	1.5	1.4
Appr. ft/lb	52	33	24	14	8.3	5.8	4.3	3.7	3.3	2.5	2.9	2.1



TYPE 4130 (GFO GRAFİTLİ TEFLON)

GORE GFO teflon ipliklere grafit emrenye edilerek yüksek sıcaklığa karşı dayanımı artırılmış olup, mükemmel kimyasal dirence sahiptir.

Sıcaklık	: -150 - +260 C
pH	: 0-14
Hız	: 12 m/s
Basınç	: 20-150 bar



TYPE 4200 (SAF GRAFİT)

Saf grafit ipliklerden imal edilmiş olup, geniş pH ve sıcaklık aralıklarında pompa ve vanalarda kullanıma uygundur. Düşük sürtünme direncine sahiptir.

Sıcaklık	: -220 - +550 C
pH	: 0-14
Hız	: 2 m/s
Basınç	: 50-400 bar



TYPE 4210 (TEFLONLU GRAFİT)

Saf grafit ve teflon ipliklerden imal edilmiş olup, silikon yağı emdirilmiştir. Böylelikle Type 4130 a daha ekonomik bir alternatif olarak geliştirilmiştir.

Sıcaklık	: -150 - +280 C
pH	: 0-14
Hız	: 12 m/s
Basınç	: 15-200 bar



TYPE 4220 (KÖŞELERİ ARAMİDLİ GRAFİT)

Bu örgü salmastra Type 4130 ile aramidin birleştirilmesiyle oluşmuştur. Köşelerin aramidten örülmesiyle salmastranın yuvarlaklaşma ve dağılmasının önüne geçilmiştir. Pistonlu pompalar, reaktörler ve mikserler için idealdir.

Sıcaklık	: -150 - +280 C
pH	: 2-12
Hız	: 15 m/s
Basınç	: 25-200 bar

ÖLÇÜLER:

Size mm	4	5	6	8	10	12	14	15	16	18	20	25
appr. m/kg	43.7	28	19.5	10.9	7.0	4.8	3.5	3.1	2.7	2.2	1.7	1.1
Appr. ft/lb	65	25	28.9	16.2	10.4	7.2	5.3	4.7	4.1	3.3	2.5	1.6



TYPE 4300 (SAF ARAMİD)

Saf aramid ipliklere asal bir yağ empenye edilmesiyle imal edilmiş olup, ürüne karışma riski olmaması sebebiyle gıda firmalarında özellikle tercih edilmektedir.

Sıcaklık : -100 - +280 C
pH : 2-12
Hız : 25 m/s
Basınç : 25-200 bar



TYPE 4310 (TEFLONLU ARAMİD)

Saf aramid ipliklere teflon ve asal bir yağ empenye edilmesiyle imal edilmiştir. Bu ürün kimyasallara ve aşınmaya karşı iyi direnç gösterir.

Sıcaklık : -100 - +280 C
pH : 2-12
Hız : 25 m/s
Basınç : 25-200 bar



TYPE 4310 (TEFLONLU ARAMİD)

Kenarların saf teflon, köşelerin ise saf aramid ipliklerle örülmesiyle üretilmiştir. Bu yapıdaki teflon, ürünün yağlama yeteneğini artırmış olup, köşelerdeki aramid ise kopma ve parçalanmaya karşı dayanımını artırır.

Sıcaklık : -100 - +280 C
pH : 2-12
Hız : 12 m/s
Basınç : 20-180 bar

ÖLÇÜLER:

Size mm	6	8	10	12	12.7	14	15	16	18	20	22
appr. m/kg	19.0	11.0	7.0	4.8	4.3	3.5	3.1	2.7	2.1	1.75	1.42
Appr. ft/lb	28.3	16.4	10.4	7.1	6.4	5.2	4.6	4.0	3.1	2.6	2.12

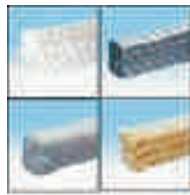

REVİZYON VE BAKIM



Revizyon ve bakım işlemleri yapılarak santrifüj pompa ve lobe(loblu) pompaların ideal çalışma şartlarına uygun hale getirilmesi sağlanır.



Mekanik salmastra ve buhar başlıklarının deforme olmuş yüzeyleri yenileriyle değiştirilir veya çeşitli imalat prosesleriyle revize edilerek tekrar kullanıma sunulur. Revizyon işlemi sonucunda daha az maliyetli yeni bir mekanik salmastra elde edilmiş olur.

KARBON İMALATI

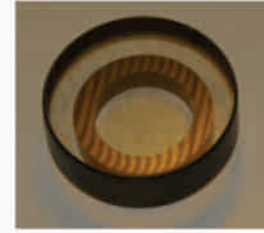
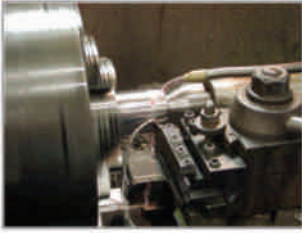

Mekanik salmastra, karbon yüzeyler, buhar başlığı ve tribün karbonları ile yataklık karbonlar ve karbon burçların imalatı genel olarak yukarıdaki prosese göre yapılarak son halini alır.



Ayrıca Silisyum Karbür, Sinter Silisyum Karbür, Tungsten Karbür, Seramik gibi mekanik salmastra Elemanları da ürünlerimiz arasında bulunmaktadır.





www.utekseal.com

UTEK Sızdırmazlık Ürünleri Makina Maden San. Tic. Ltd. Şti.

Demirciler Sitesi E 2 Blok No: 373

OSB-İkitelli / İSTANBUL

Tel : 0 212 671 97 82

Fax : 0 212 671 46 40

info@utekseal.com

